



Measuring probe for water level, Ceramic measuring cell

Technical specifications:

Meas. ranges:	0 - 200 mbar / 250 mbar / 400 mbar
Output:	4 ... 20 mA, 2-Ader-Prinzip, standard.
Supply voltage:	10 ... 30 V DC
Measuring cell:	Ceramic Al ₂ O ₃ , DMS measuring bridge
Response time:	Response time < 50 ms Power-up time < 500 ms
Error:	< 1.0 % FSO
Thermal drift:	< 0.05 % / K in offset < 0.05 % / K in gain
Ambient Temp.:	-10 ... +40 °C (in some cases higher)

- Universal immersion probe type TDS-52xxx
- Good accuracy, deviation < 1.0%
- Main field of application water

Electrical connection:

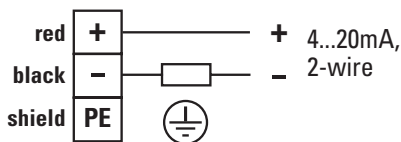

U = 12...30 V DC

Housing:	Stainless steel 1.4404 (316 L, V4A). Large bore to the measuring cell, 11 mm. No protective cap.
Probe head:	Diameter 22 mm Weight approx. 0.2 kg, without cable
Cable:	PUR black. With capillary for air pressure equalization.
Application areas:	Water, gray water, drinking water, Aqueous liquids, cisterns.

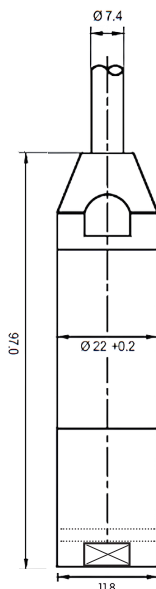

Article code:

